

FLOW AREA: 20.83 IN²

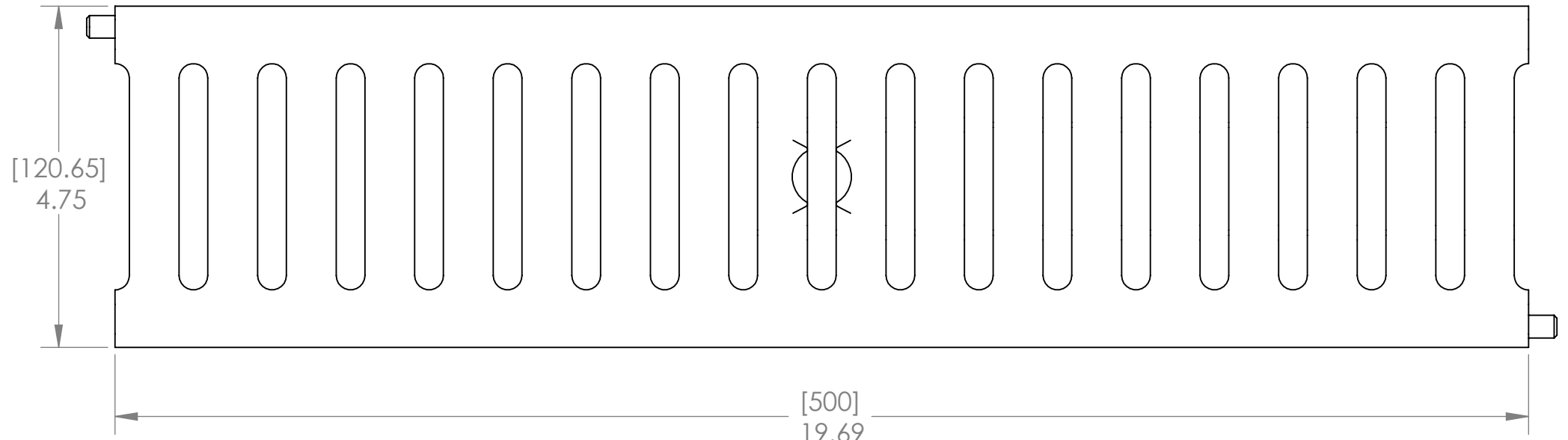
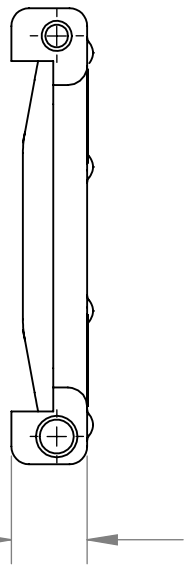
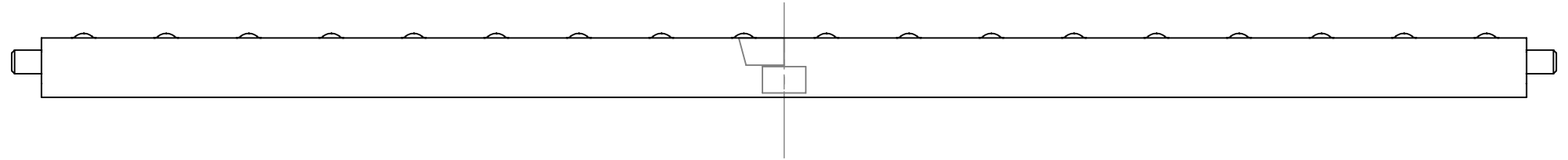

PROPRIETARY AND CONFIDENTIAL
 THE INFORMATION CONTAINED IN THIS DRAWING IS THE SOLE PROPERTY OF LIGHTHOUSE INDUSTRIES. ANY REPRODUCTION IN PART OR AS A WHOLE WITHOUT THE WRITTEN PERMISSION OF LIGHTHOUSE INDUSTRIES IS PROHIBITED.

		UNLESS OTHERWISE SPECIFIED:		NAME	DATE	Quick Trench Series 6 Lighthouse Industries 107 Eastwood Road Michigan City, IN 46360 P: 219-879-1550 F: 219-879-1509	
		DIMENSIONS ARE IN INCHES		DRAWN	PCF		6-6-2005
				CHECKED			
				ENG APPR.			
				MFG APPR.			
		INTERPRET GEOMETRIC TOLERANCING PER:		Q.A.			
		MATERIAL		COMMENTS:			
		PP 40% TF					
NEXT ASSY		USED ON				SIZE	
						DWG. NO.	
						REV	
						0	
APPLICATION		DO NOT SCALE DRAWING		SCALE: 1:1		SHEET 1 OF 1	

Grate - Slotted PP

SIZE **B** DWG. NO. Q6-ASPP5 REV 0